

#6288 Filed This 15 day of Sept. 1970
 And Recorded in Vol. 44 Page 3 of Pl. 42.N.
 Ollie Farnsworth
 Register Mesne Conveyance Greenville County, S. C.

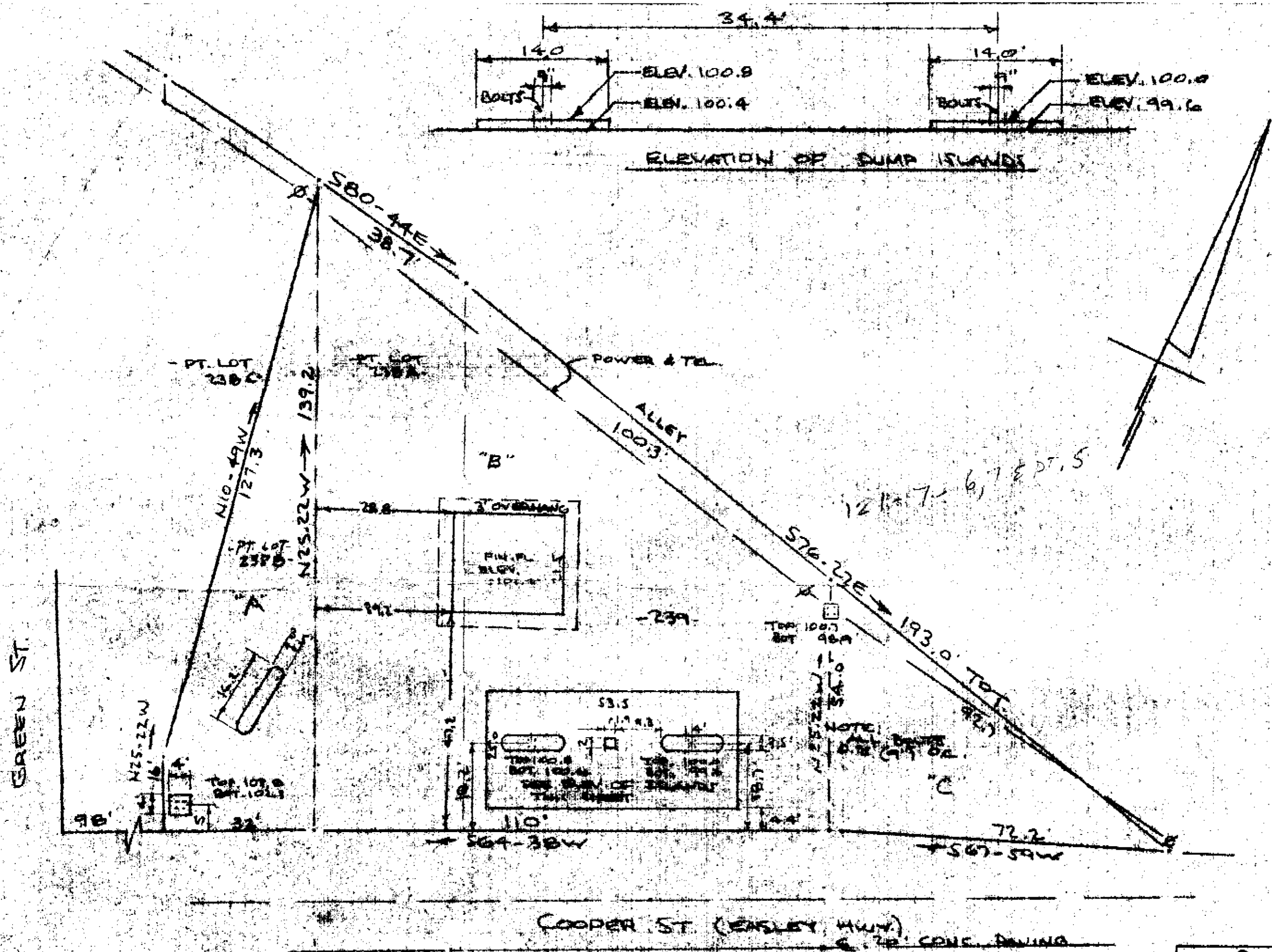

FILED
 GREENVILLE CO. S. C.
 SEP 15 9 15 AM '70
 OLLIE FARNSWORTH
 R.M.C.

H H - 3

SEP 15 1970
 #288

SURVEY FOR
 INTERSTATE STATIONS INC.
 GREENVILLE, S. C.
 SCALE 1" = 20'
 REVISED 21 MAY 1970
 30 JUNE 1970
 CAROLINA ENGINEERING
 & SURVEYING CO.
 GREENVILLE, S. C.